

Yubune

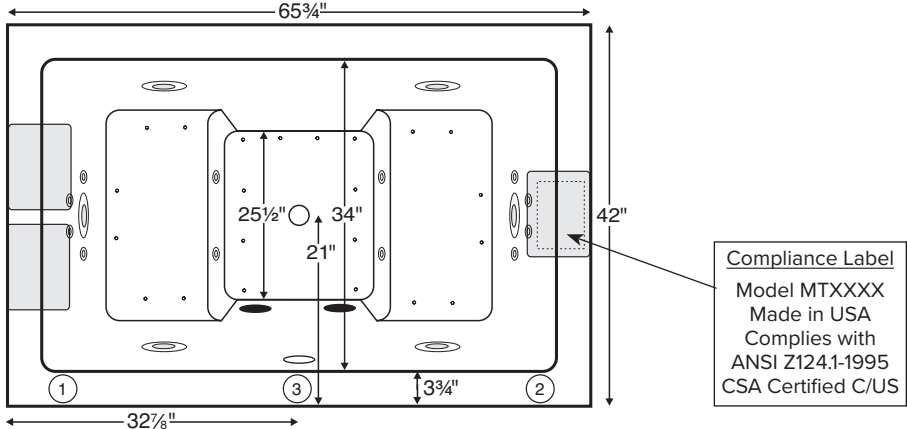

MODEL 77
65.75" x 42" x 32.875"
DROP-IN or UNDERMOUNT <i>Not recommended as a tub/shower combination</i> 155 gal to overflow
Acrylic CXL™
140 lbs / 64 kg soaker 171 lbs / 76 kg plumbed
Filling this tub to the maximum may require an above average size or dedicated water heater.



Numbered areas on tub deck represent possible locations to install cleaning systems, faucets and other fixtures. Shown with Air Massage and Ultra Whirlpool Package.

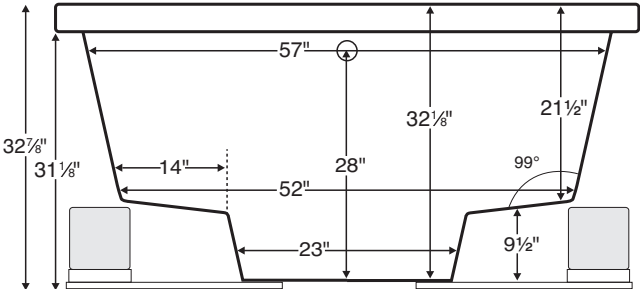

IMPORTANT:
Air baths and tubs with a pre-leveled foam base add 2-3" to overall tub height.

IMPORTANT ORDERING & INSTALLATION INFORMATION

- Before ordering or installing, please consider future access to equipment.
- Add proper bedding compound to fully level and support bottom of tub.
- When equipped with an air bath package, pre-leveled foam base or frame system, overall tub height is increased by approx. 2-3" and is designed to install on a flat, level subfloor.
- Radiance placed on airbath floor will affect placement of air jets.
- System components may extend beyond the perimeter of deck.
- Measure tub **on-site** before building tub decking.
- Advise MTI when planning to use a glass enclosure. Relocation of controls may be necessary.
- Suction and control locations may vary.
- All tubs are compliant with ASTM C 1028-07 coefficient of friction.

ELECTRICAL COMPONENTS & SPECIFICATIONS

Hydrotherapy Package	Components Included	GFCI / 110V
Standard Whirlpool	2-bhp pump	1-15 amp
Microbubbles	Microbubbles pump	1-15 amp
Air Massage	heated blower	1-15 amp
Air Massage Elite	heated blower, chromatherapy	1-15 amp

Hydrotherapy Package	Components Included	GFCI / 110V
Microbubbles with Air	Microbubbles pump, heated blower	1-20 amp
Microbubbles with Air Elite	Microbubbles pump, heated blower, chromatherapy	2-15 amp
Air with Whirlpool	2-bhp pump, heated blower	2-15 amp
Air Elite with Whirlpool	2-bhp pump, heated blower, chromatherapy	2-15 amp

Electrical requirements may change with the addition of optional therapy components. See specific option details or installation information. CSA Certified C/US; B45.5/IAPMO ANSI Z124.1 and ANSI 112.19.7

- See the Installation & Operation Manual for more details.
MTI's Customer Service Monday-Friday 8am-6pm EST
800-783-8827 or service@mtibaths.com
- Before discarding tub crate, check for accessories that may be packaged inside.
 - All product measurements are ±1/2".
 - Specifications and configurations are subject to change without notice.
 - Measurements herein supersede all others published prior to publication date below.



Yubune

MODEL # 77

65.75" x 42" x 32.875"

- Aromatherapy is eliminated for undermount applications
- Air Baths, Pre-Leveled Foam Base or Frame Systems increase overall height by 2-3".

Hydrotherapy Packages	Package Contents	Part #	MSRP
Soaker	Soaking bath - no jets, textured bottom	S77-DI	\$4,025
		S77-UM	
Microbubbles	1 microbubbles infusion port and pump, textured bottom	M77-DI	\$7,345
		M77-UM	
Air Massage	20 air jets, heated air blower, Aromatherapy, pre-leveled foam base, textured bottom	AST77-DI	\$7,675
		AST77-UM	
Air Massage Elite	30 air jets, heated air blower, Aromatherapy, Chromatherapy LED lighting, Spa Mode, pre-leveled foam base, textured bottom	AE77-DI	\$9,575
		AE77-UM	
Microbubbles with Air Massage	1 microbubbles infusion port and pump, 20 air jets, heated air blower, Aromatherapy, pre-leveled foam base, textured bottom	ASTM77-DI	\$10,395
		ASTM77-UM	
Microbubbles with Air Massage Elite	1 microbubbles infusion port and pump, 30 air jets, heated air blower, Aromatherapy, Chromatherapy LED lighting, Spa Mode, pre-leveled foam base, textured bottom	AEM77-DI	\$12,195
		AEM77-UM	
Standard Whirlpool	6 point-massage jets, 2-bhp pump, inline heater, textured bottom	P77-DI	\$6,880
		P77-UM	
Ultra Whirlpool	6 point-massage jets, 12 micro-jets with Tsubo massage, 2 2-bhp pumps, inline heater, Ozone, textured bottom	P77U-DI	\$9,560
		P77U-UM	
Air Massage with Standard Whirlpool	6 point-massage jets, 2-bhp pump, inline heater, 20 air jets, heated air blower, Aromatherapy, pre-leveled foam base, textured bottom	AW77-DI	\$10,530
		AW77-UM	
Air Massage with Ultra Whirlpool	6 point-massage jets, 12 micro-jets with Tsubo massage, 2 2-bhp pumps, inline heater, 20 air jets, heated air blower, Aromatherapy, Ozone, pre-leveled foam base, textured bottom	AU77-DI	\$13,210
		AU77-UM	
Air Massage Elite with Standard Whirlpool	6 point-massage jets, 2-bhp pump, inline heater, 30 air jets, heated air blower, Aromatherapy, Chromatherapy LED lighting, Spa Mode, pre-leveled foam base, textured bottom	AEAP77-DI	\$12,430
		AEAP77-UM	
Air Massage Elite with Ultra Whirlpool	6 point-massage jets, 12 micro-jets with Tsubo massage, 2 2-bhp pumps, inline heater, 30 air jets, heated air blower, Aromatherapy, Ozone, Chromatherapy LED lighting, Spa Mode, pre-leveled foam base, textured bottom	AEAP77U-DI	\$14,210
		AEAP77U-UM	

RECOMMENDED SENSORY THERAPIES

Chromatherapy

(LE) **\$800** underwater lighting
2 LED lights included

Audiotherapy

(STEREOBT) **\$1,390** 2 transducers with bluetooth and amplifier
(BTREMOTE) **\$600** bluetooth remote

(STEREOH202) **\$1,575** 4 transducers amplifier not included

Thermaltherapy

(RAD100) **\$1,595** Radiance®
2 heated zones included
(HTISOAK) **\$825**



For more information on options and accessories go to Acrylic Tub Options on mtibaths.com

Yubune
MODEL # 77

Options <i>Must be ordered at time of purchase.</i>
Standard Colors White (CWH) only
Quick Ship reduces lead time (QSPRI) \$430 <i>Please call for availability</i>
Inline Heater maintains water temperature For Soaker or Air Baths (HTISOAK) \$825 Includes a recirculating pump <i>Cannot be combined with Microbubbles.</i>
Virtual Spout high-flow integrated tub filler (FPMJ) \$450 <i>Must specify stub-out location on order. See page 1 for location options.</i>
Grab Bars from \$330 <i>Selections vary. Personalization available.</i>
Accessories
Pillows from \$180
Teak Bath Mat (TKMAT3018) \$815 <i>Custom sizes also available. Contact MTI for details and pricing.</i>
Teak Tub Tray Slatted (TK-TRAY1) \$500 Solid (TK-TRAY2) \$570

Hydrotherapy Equipment & Cleaning Systems <i>Must be ordered at time of purchase.</i>
Inline Heater maintains water temperature For Whirlpools or Stream Bath (HTI) \$570 Uses existing pump <i>Cannot be combined with Microbubbles.</i>
Whirlpool Cleaning Systems Fill-Flush (FFSO) \$590 Simple Touch (FFE) \$1,020 <i>Must specify stub-out location on order. See page 1 for location options.</i>
Whirlpool Jets Pump upgrade may be advisable for optimal performance when adding jets. Point-Massage Jet Extra Point-Massage Jet (EJ) \$315 Micro-Jet from \$360 <i>Jet styles and packages vary. Personalization available.</i>
Pump Upgrade - 3-bhp (PUMP3) \$315
Jet Trim Kits For Standard Whirlpool Chrome (TRC) \$270 , Brushed Nickel (TRBN) \$725 For Ultra Whirlpool Chrome (TRCU) \$370 , Brushed Nickel (TRBNU) \$960
Ozonator (OZONE) \$515 <i>Cannot be added to soakers or airbaths without combination hydrotherapy package or HTISOAK.</i>

Installation Options *Must be ordered at time of purchase.*

Pre-Leveled Foam Base (PLFOAM) \$295
All airbaths include a pre-leveled foam base.

Tile Flange
Factory-Installed on 3 sides - rigid ABS (TFK3) \$200
Field Install Kit - includes rigid ABS & adhesive (TFKNI) \$185
IMPORTANT: *Must specify flange location(s) on order of Factory-Installed Flange. Not available with optional Low-Profile Rim.*

Drains & Overflow Kits *Toe Tap Rectangular Overflow must be ordered at time of purchase*

Cable Driven
Drain Finishes – PVC Drain Kit
White/Biscuit (WOCDW) **\$440**
Chrome (W OCD) **\$410**
Brushed Nickel (WOCDBN) **\$490**
Polished Nickel (WOCDPN) **\$540**
Oil-Rubbed Bronze[†] (WOC DOR) **\$550**
Polished Brass (WOCDBR) **\$690**
Special Finishes* (WOCDSF) **\$1,135**
MTI does not offer a brass body cable drain kit.

Toe Tap
Round Overflow – PVC Drain Kit
Chrome (WOTTC) **\$380**
Brushed Nickel (WOTTBN) **\$385**
Polished Nickel (WOTTPN) **\$385**
Special Finishes* (WOTTSF) **\$1,145**
Round Overflow – Solid Brass Drain
Chrome (WOTT SBC) **\$810**
Brushed Nickel (WOTT SBBN) **\$810**
Polished Nickel (WOTT SBPN) **\$810**

Toe Tap
Rectangular Overflow – PVC Drain Kit
Chrome (WOTRC) **\$470**
Brushed Nickel (WOTRBN) **\$430**
White (WOTRW) **\$525**
Lift & Turn
Drain Finishes – PVC Drain Kit
Chrome (WOC) **\$185**
White (WOW) **\$245**
Brushed Nickel (WOBN) **\$305**

Slim-Line Overflow with Toe Tap Drain *Must be ordered at time of purchase.*

- Low profile overflow is factory installed
- Overflow measures 4.5" x 1"
- Provides a deeper soak
- Not available for commercial applications

Slim-Line Overflow with Toe Tap Drain
PVC Drain
Chrome (SLOT C) **\$500**
Brushed Nickel (SLOTBN) **\$530**
Polished Nickel (SLOT PN) **\$555**
White (SLOTW) **\$430**

Slim-Line Overflow with Toe Tap Drain
Solid Brass Drain
Chrome (SLOTSBC) **\$930**
Brushed Nickel (SLOTSBBN) **\$935**
Polished Nickel (SLOTSBPN) **\$935**
White (SLOTSBW) **\$965**

[†] MTI has selected an oil-rubbed bronze finish that is compatible with Delta and many other manufacturers. To ensure best match, order as a Special Finish and submit a sample. CSA # MTDS-77

* Allow 2-4 weeks lead time for Special Finishes. Send sample for best match.

