



NITRO DISPENSING KIT
Single Infuser



*RS-NDK installed
in HP24 unit*

JOB	
AREA	
ITEM NO.	
MODEL NO.	

MODEL	
RS-NDK	Single Infuser Kit

KEY PRODUCT FEATURES AND BENEFITS

- Take your beverage to the next level by infusing it with nitrogen for a lasting cascading effect and a smooth, creamy and slightly sweet flavor.
- Beverages such as coffee, tea, beer and others can be poured using the Perlick Nitro Dispensing Kit to elevate your beverage dispensing capabilities
- Kit allows connection to a tower with up to 4 faucets to maximize dispensing options
- Pair with Perlick’s superior refrigeration for a durable and reliable dispensing system you can trust
- Quick disconnects minimize labor and make it easy and efficient to change kegs

Quick Features:

- Nitrogen infuser connects to one keg, but kit allows up to 4 beverages to be dispensed from the same tower
- The Perlick Nitro Dispensing kit includes infuser, hoses, and connections, 6-way distributor, regulator assembly, air sleeve and air baffle
- Kit pairs with HP and HC series refrigerators
- Requires pairing with tower that has 304 stainless steel shanks
- Kegs with quick disconnects available in 2.5 gallons (CC2.5NAT) or 5 gallons (CC5NAT)
- Recommended drainer: 67782
- Nitrogen infused beverages dispense best from stout faucet: 63927
- Nitrogen tank required for dispensing: 1013578



NITRO DISPENSING KIT
Single Infuser

Single Infuser Kit (RS-NDK) Includes:

ITEM NO.	DESCRIPTION	QTY.
1	Infuser, Single Nitrogen	1 ea.
2	Disconnect, Ball-lock, For Gas (Gray)	4 ea.
3	Disconnect, Ball-lock, For Liquid (Black)	4 ea.
4	Silicone	1 ea.
5	Red Gas Line	30 ft.
6	Beverage Tubing	5 ea.
7	Distributor, Air, 6-way	1 ea.
8	Snorkle Tubing	5 ft.
9	Bushing	1 ea.
10	Air Sleeve	1 ea.
11	Regulator, Nitrogen Twin-gauge	1 ea.
12	Air Scoop	1 ea.
13	Nitro Installation Instructions	1 ea.
14	Mounting Template, 1031011	1 ea.
15	Dispensing Tower Installation Instructions	1 ea.
Page 3	Tapping Parts Bag	1 ea.

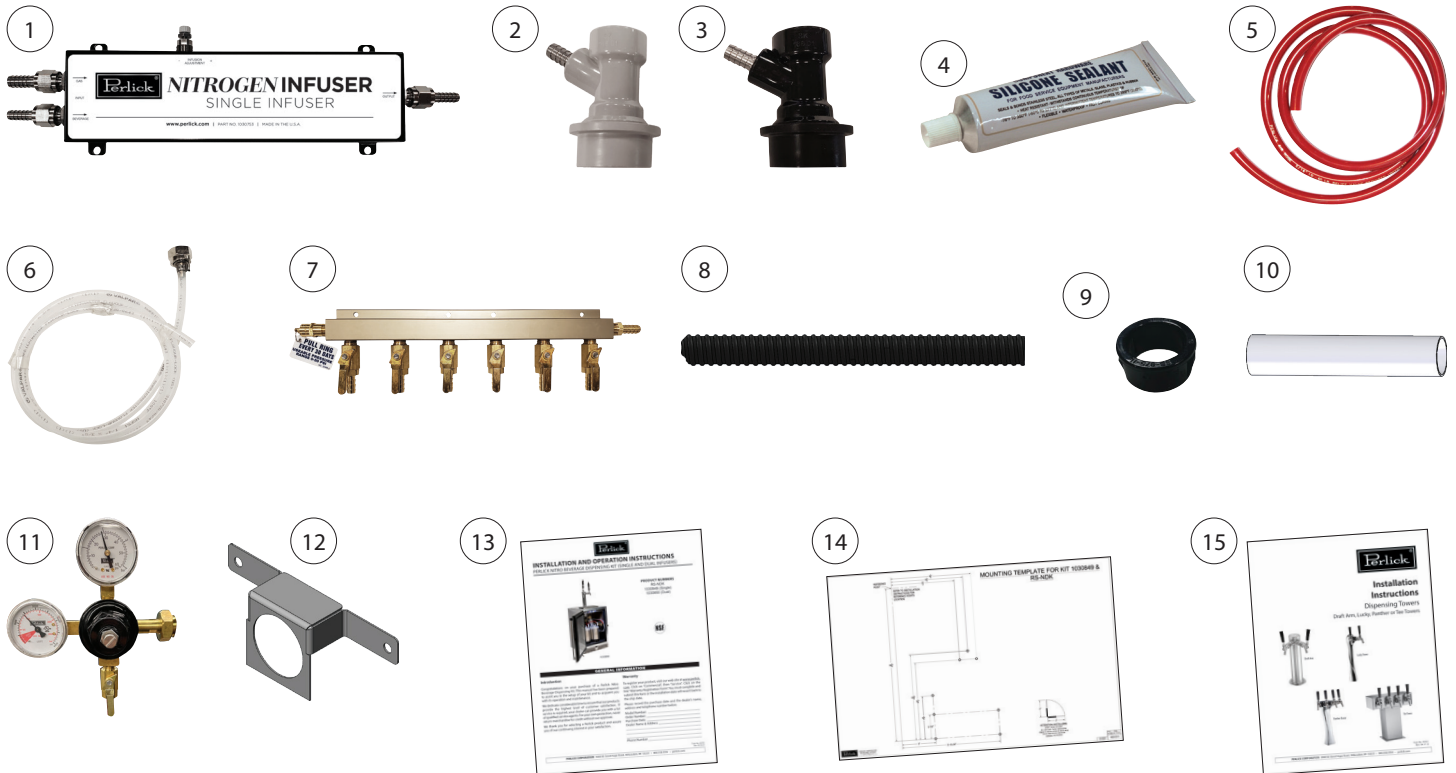



NITRO DISPENSING KIT
Single Infuser

Tapping Parts Bag Includes:

ITEM NO.	DESCRIPTION	QTY.
1	Coupling Gasket	10
2	Clamp, Stainless Steel Worm Drive	19
3	Combination Wrench	1
4	Elbow, Nylon, 3/4" FPT X 1/2" Hose Barb	1
5	Screw, Self-drilling, #10 X 3/4", Hex Washer Head With Serrations	8
6	Tee, 1/2" Insert, Three Hose Barb	1
7	Bushing, Reducer, Nylon, 3/4" NPT, 1/2" NPT	1
8	Bushing, Snap, 1.5", Nylon	4
9	Bushing, Snap, 2", Nylon	2
10	Clamp, Cable, 3/4" DIA X 1/2", Plastic	3
11	Cable Tie	1
12	Clamp, Stepless Ear, Stainless Steel (Oetiker Clamp)	19

